

PART OF LOT 26  
CONCESSION VIII  
TOWNSHIP OF NORTH DUMFRIES

PART OF LOT 38  
CONCESSION VII  
TOWNSHIP OF NORTH DUMFRIES

PART OF LOT 1  
CONCESSION VIII  
TOWNSHIP OF NORTH DUMFRIES  
(BEVERLY SECTION)

THIS IS SCHEDULE 'A' TO BY-LAW 689-83,  
PASSED THIS 18th DAY OF July, 1983.

Franklin A. Liso  
SAYOR

Harry Griffin  
CLERK

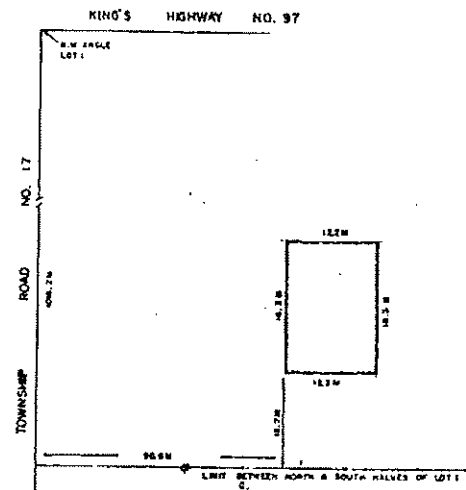
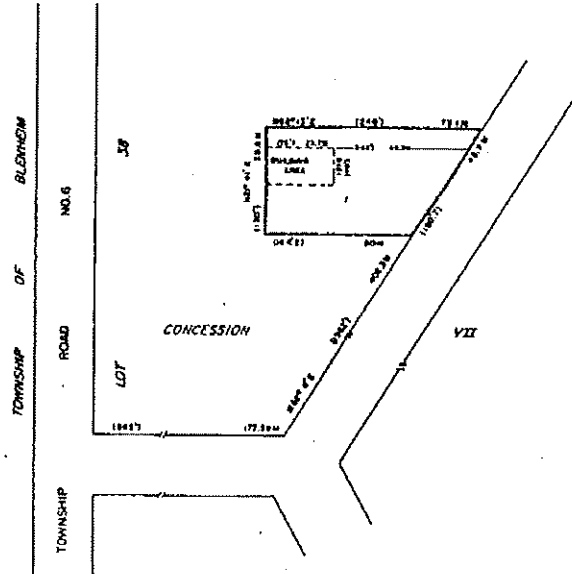
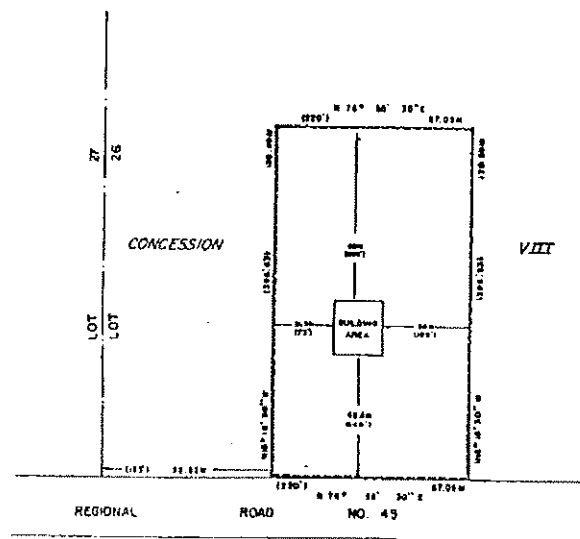

CONCESSION VII

NOTE: APPROXIMATE IMPERIAL EQUIVALENTS SHOWN IN BRACKETS.

THIS IS SCHEDULE 'A' TO BY-LAW 689-83,  
PASSED THIS 18th DAY OF July, 1983.

Franklin A. Liso  
SAYOR

Harry Griffin  
CLERK

NOTE: APPROXIMATE IMPERIAL EQUIVALENTS SHOWN IN BRACKETS.  
THIS IS SCHEDULE 'A' TO BY-LAW 1241-90,  
PASSED THIS 7th DAY OF MAY, 1990.

J. WARTENS  
SAYOR

M. ROSETTI  
CLERK

SCALE: 1:1250  
SEE PART 37-SCHEDULE 'B'

SECTION 20.1.7

SEE PART 21-SCHEDULE 'B'  
SCALE: 1:1250

SECTION 20.1.8

SEE PART 15-SCHEDULE 'B'  
SCALE: 1:500

SECTION 20.1.9