

PART OF LOT 35
CONCESSION X
TOWNSHIP OF NORTH DUMFRIES

NOTE: APPROXIMATE IMPERIAL EQUIVALENTS SHOWN IN BRACKETS.

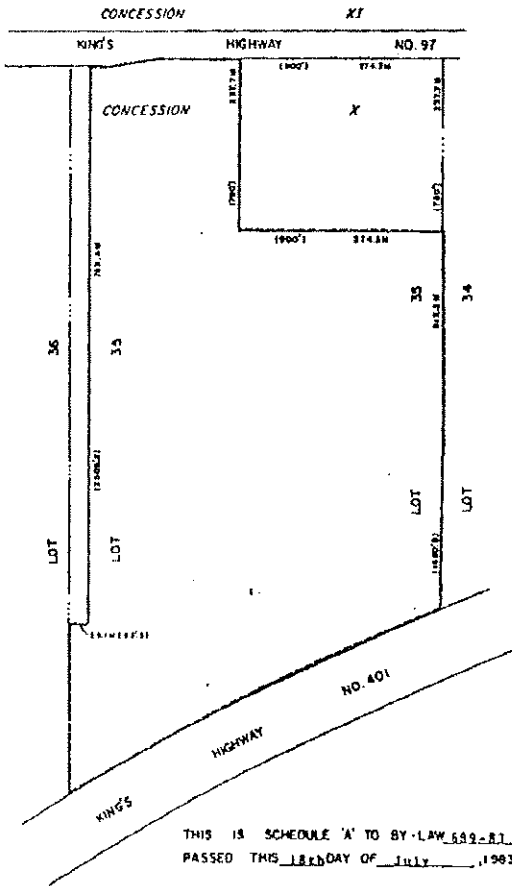

THIS IS SCHEDULE 'A' TO BY-LAW 689-83,
PASSED THIS 18th DAY OF JULY, 1983.

Franklin A. Lisso
MAYOR
Harry Griffin
CLERK

PART 73 - SCHEDULE 'B'
SCALE: 1:5000

SECTION 20.1.49

PART OF LOT H
CONCESSION VIII
TOWNSHIP OF NORTH DUMFRIES
(BEVERLY SECTION)

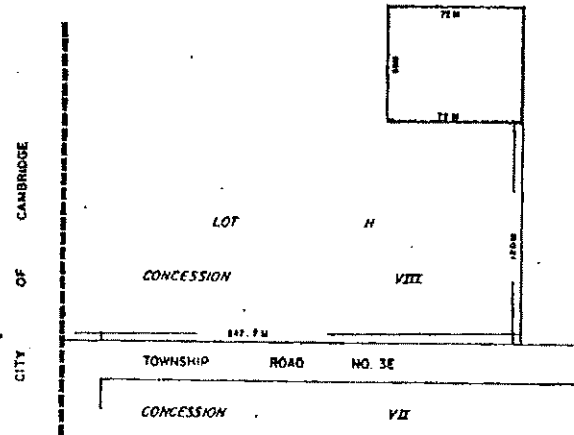

THIS IS SCHEDULE 'A' TO BY-LAW 689-83,
PASSED THIS 18th DAY OF JULY, 1983.

Franklin A. Lisso
MAYOR
Harry Griffin
CLERK

SEE PART 109 - SCHEDULE 'B'
SCALE: 1:2000

SECTION 20.1.50

PART OF LOT 5
CONCESSION X
TOWNSHIP OF NORTH DUMFRIES
(BEVERLY SECTION)

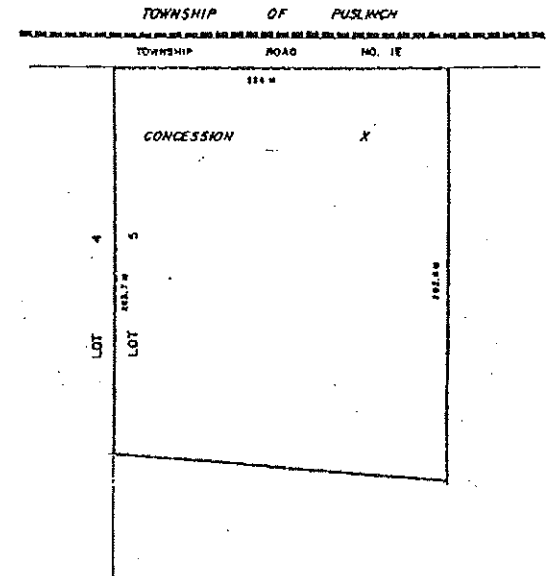

THIS IS SCHEDULE 'A' TO BY-LAW 689-83,
PASSED THIS 18th DAY OF JULY, 1983.

Franklin A. Lisso
MAYOR
Harry Griffin
CLERK

SEE PART 135 - SCHEDULE 'B'
SCALE: 1:2500

SECTION 20.1.51